



SUH30N-MS30G

Sliding Air Cutters



SIDE

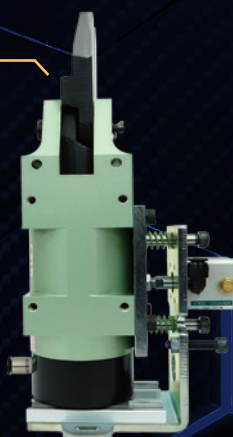

BACK



- Suitable for big gate cutting
- Maximum stroke: 10mm
- Adjustable blade opening
- Stable operation by a guide rail
- Changeable air supply port from the side to the bottom.

- The guide rail part may wear faster depending on the installed direction
- Blades are sold separately.
- Lubrication of the nipper body is not necessary, but the cylinder for sliding is recommended to lubricate.

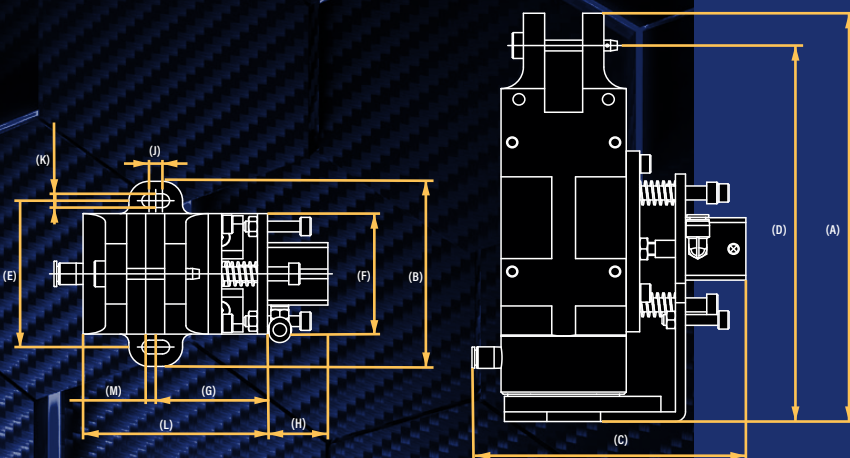

Part No.	Weight (g)	Air consumption (m ³ /Stroke)	Air pressure (MPa)	Air pressure for sliding cylinder (MPa)	DIMENSIONS (mm)											
					A	B	C	D	E	F	G	H	J	K	L	M
SUH30N-MS30G	1500	631	0.5~0.6	0.5~0.6	(189.7)	86	(122.5)	(174.7)	68	56	50	27	6	(6.4)	(82.5)	4.5
SUH20N-MS20G																

0.55MPa is required when using maximum stroke length.



GATE CUTTING BLADE

End cutting edge

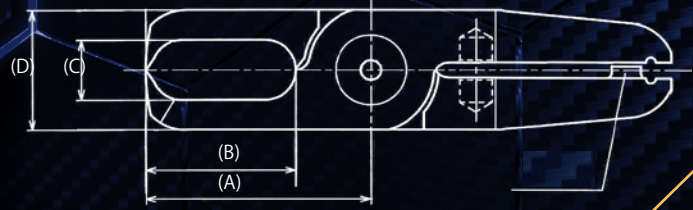
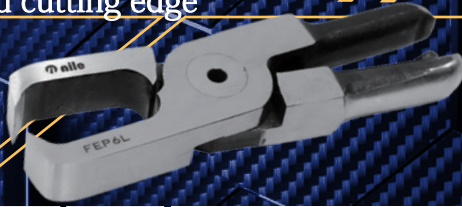

Part No.	Suitable Body	Dimensions (mm)				Cutting capacity (φmm)	Blade opening (mm)	Blade length (mm)
		A	B	C	D			
FEP4L	MS10G	30	19	8	19	4.0	6	9
FEP6L	MS20G	45	30	12	24	7.0	12	12

L-shaped type

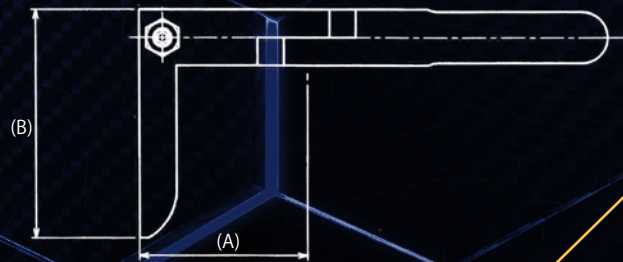

Part No.	Suitable Body	Dimensions (mm)				Cutting capacity (φmm)	Blade opening (mm)	Blade length (mm)
		A	B	C	D			
F5LT	MS20G	36	49			6.0	8	26
F9PL	MS30G	50	55			7.0	10	32

Crank shaped type

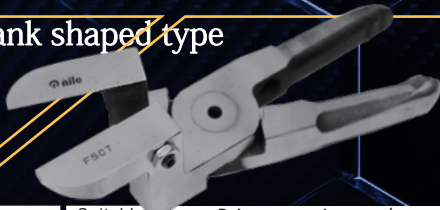

Part No.	Suitable Body	Dimensions (mm)				Cutting capacity (φmm)	Blade opening (mm)	Blade length (mm)
		A	B	C	D			
F5CT	MS20G	55	30	37		6.0	10	25
F9PC	MS30G	70	41.5	45		7.0	15	30

Carbide tipped

Excellent durability for gate cutting of hard resins such as glass-filled resins and polycarbonate.

Straight type

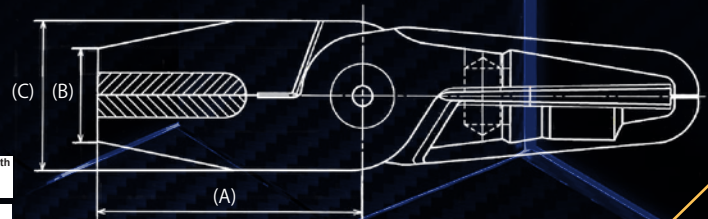

Part No.	Suitable Body	Dimensions (mm)				Cutting capacity (φmm)	Blade opening (mm)	Blade length (mm)
		A	B	C	D			
ZF5S	MS20G	35		23		7.0	8	16
ZF9PS	MS30G	66	23	23		10.0	16	37

Angled edge type

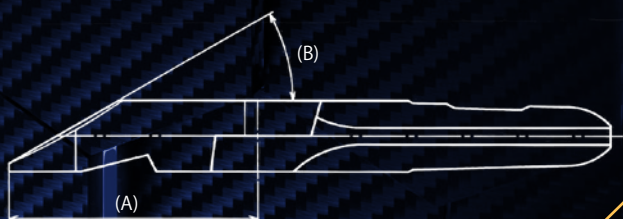

Part No.	Suitable Body	Dimensions (mm)				Cutting capacity (φmm)	Blade opening (mm)	Blade length (mm)
		A	B	C	D			
ZFD5	MS20G	35	40°			7.0	8.5	14
ZFD9P	MS30G	59	30°			10.0	14	27